

NO	PART NAME	Q'TY	MATERIAL	NOTE	PART NO.
06	FRIST CASING	1	ETFE	φ143X32.5	1007010421
05-1	RING	1	S45C	2.2 kW 1.5 kW 0.75 kW	
05	OUTER DRIVE RING	1	FCD-45	2.2 kW 1.5 kW	1007010720
04	IMPELLER ASS'Y	5	ETFE	0.75 kW	100311800
03	REAR CASING ASS'Y	1	ETFE	φ139X93.3	1007010201
02-1	FLANGE	2	ETFE	φ122X31	1001007100
02	FRONT CASING	1	ETFE	210X48	1007012301
01-3	TRANSITION FLANGE	1	FC-20	2.2 kW 1.5 kW 0.75 kW	
01-2	OUTER CASING COVER	1	SUS304	φ145.2X146	1007010980
01-1	BASE PLATE	1	FC-20	170X160X7.5	1007010600
01	BRACKET	1	ADC-12	2.2 kW 1.5 kW 0.75 kW	1007010502 1007010501

NO	PART NAME	Q'TY	MATERIAL	NOTE	PART NO.	NO	PART NAME	Q'TY	MATERIAL	NOTE	PART NO.	NO	PART NAME	Q'TY	MATERIAL	NOTE	PART NO.
15	O. RING	1	FKM	G130	1007012700	24	HEXAGON SOCKET BOLT	4	SUS304	3/8" - 16X1"							
14	CHAMBER GASKET	5	FKM	φ129.4Xφ3.1		23	NUT	4	SUS304	M10							
13	BACK UP RING	1	SPCC	φ139X4	1007010300	22	COUNTER SUNK HEAD BOLT	4	S45C	M8X25							
12	INNER DRIVE RING	1	Nd-Fe-B	2.2 kW 1.5 kW 0.75 kW	1007112353 1007112352	21	STUD BLOT	4	SUS304	M10X205	1007010920						
11	CLUTCH	1	Sr.FERRITE	φ58X12.5	1003912371	20	w/t P.W. + S.W. (M10)	2	S45C	M6X10							
10	FRONT THRUST BEARING	1	ETFE	φ56X18	1003010812	19	SET SCREW	2	S45C	M8X10							
09	BEARING ASS'Y	1	ETFE	φ44X31	1003010812	18	SET SCREW	1	FKM	P20	1001301300						
08	LAST CASING	1	ETFE	φ143X40	1007010422	17	O. RING	2	FKM	G90	1007012701						
07	MID CASING	3	ETFE	φ143X40	1007010420	16	O. RING	1	FKM	G90	1007012701						

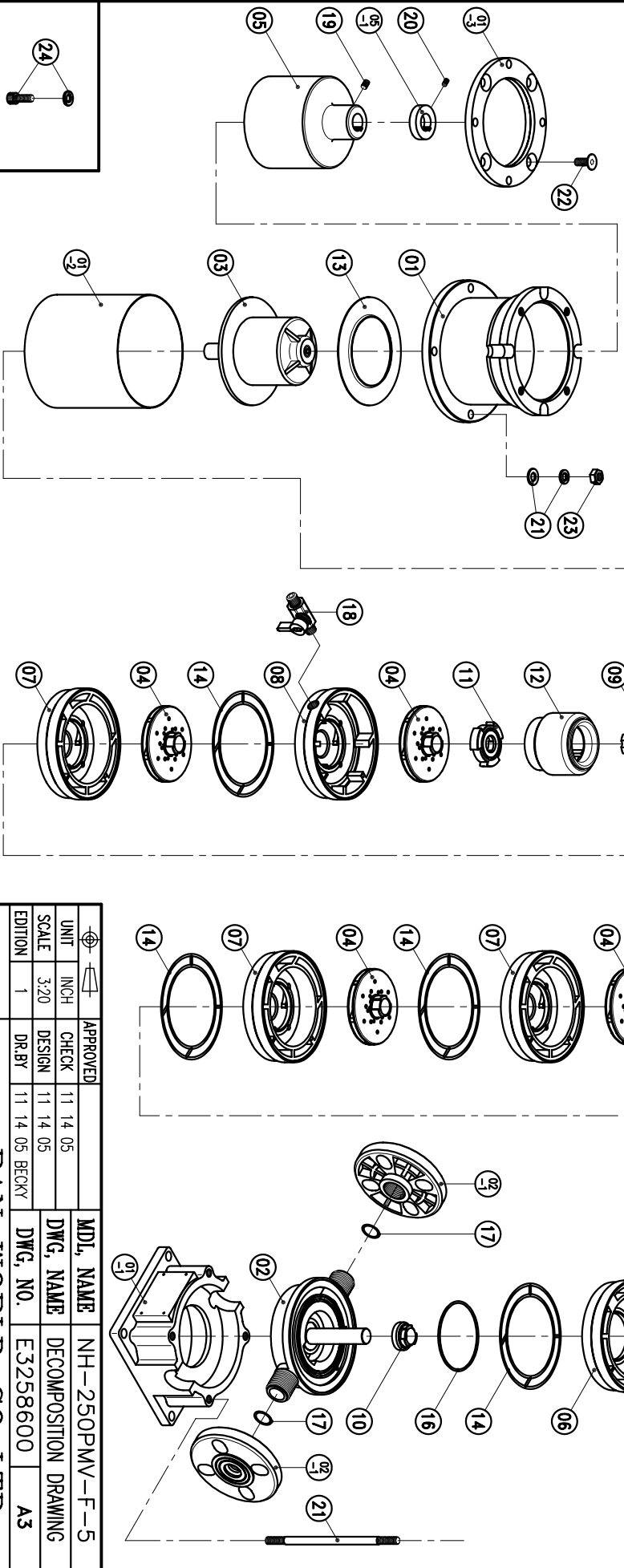

APPROVED	CHECK	DESIGN	DR.BY	MDL. NAME	DWG. NAME	DWG. NO.
11 14 05	11 14 05	11 14 05	11 14 05	NH-250PMV-F-5	DECOMPOSITION DRAWING	E3258600
UNIT INCH			SCALE 3:20			
EDITION 1			A3			

TPW  
HONG YUAN

**PAN WORLD CO., LTD.**  
PANワールド株式会社

MOTOR FLANGE