

NO	PART NAME	Q'TY	MATERIAL	NOTE	PART NO.	NO	PART NAME	Q'TY	MATERIAL	NOTE	PART NO.	NO	PART NAME	Q'TY	MATERIAL	NOTE	PART NO.
06	FRIST CASING	1	PPS	φ143X32.5	1007010421	15	O. RING	1	FKM	G130	1007012700	24	HEXAGON SOCKET BOLT	4	SUS304	3/8" - 16X1"	
05-1	RING	1	S45C	2.2 kW		14	CHAMBER GASKET	5	FKM	φ129.4Xφ3.1	1007010300	23	NUT	4	SUS304	M10	
				1.5 kW		13	BACK UP RING	1	SPCC	φ139X4	1007010300	22	COUNTER SUNK HEAD BOLT	4	S45C	M8X25	
				0.75 kW		12	INNER DRIVE RING	1	Nd-Fe-B	2.2 kW	1007112353	21	STUD BLOT	4	SUS304	M10X205	1007010920
05	OUTER DRIVE RING	1	FCD-45	2.2 kW	1007010720				Sr.FERRITE	0.75 kW	1003912371	20	w/t P.W. + S.W. (M10)	2	S45C	M6X10	
				1.5 kW		11	CLUTCH	1	PPS	φ58X12.5	1007010400	19	SET SCREW	2	S45C	M8X10	
04	IMPELLER ASS'Y	5	PPS	0.75 kW	100311800	10	FRONT THRUUST BEARING	1	PPS	φ56X18	1003010811	18	EXHAUST VALVE	1	FKM	P20	1001301300
03	REAR CASING ASS'Y	1	PPS	φ139X93.3	1007010201	09	BEARING ASS'Y	1	ETFE	φ44X31	1003010812	17	O. RING	2	FKM	P20	1001301300
02-1	FLANGE	2	PPG	φ122X31	1001007100	08	LAST CASING	1	PPS	φ143X40	1007010422	16	O. RING	1	FKM	G90	1007012701
02	FRONT CASING	1	PPS	210X48	1007012301	07	MID CASING	3	PPS	φ143X40	1007010420						
01-3	TRANSITION FLANGE	1	FC-20	2.2 kW													
				1.5 kW													
01-2	OUTER CASING COVER	1	SUS304	φ145.2X146	1007010980												
01-1	BASE PLATE	1	FC-20	170X160X75	1007010600												
01	BRACKET	1	ADC-12	2.2 kW	1007010502												
				1.5 kW													
				0.75 kW	1007010501												

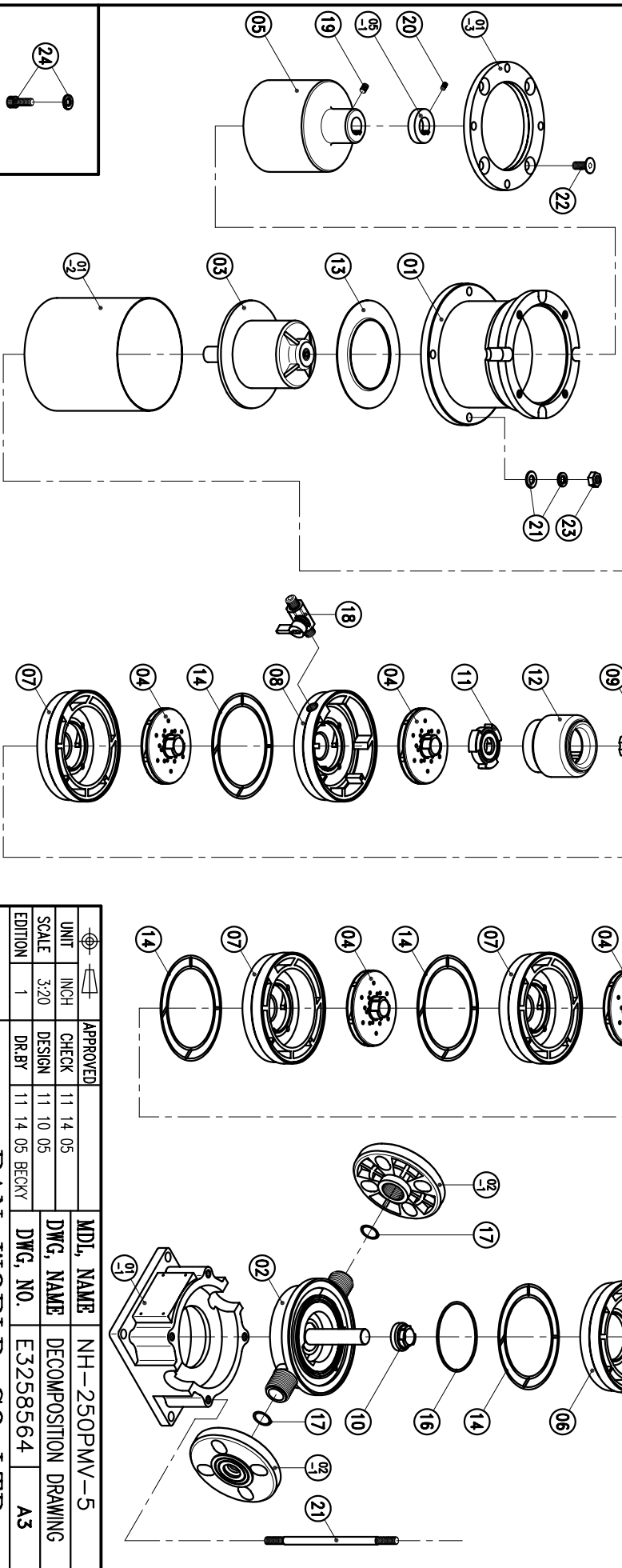

UNIT	INCH	CHECK	11	14	05	MDL NAME	NH-250PMV-5
SCALE	3:20	DESIGN	11	10	05	DWG. NAME	DECOMPOSITION DRAWING
EDITION	1	DR.BY	11	14	05	DWG. NO.	E3258564
							A3

MOTOR FLANGE

TPW
HONG YUAN



PAN WORLD CO., LTD.
パンワールド株式会社