

03-1	REAR THRUST PAD	1	PPS	φ12Xφ9X3	P2329477	05	OUTER DRIVE RING	1	CERAMIC	φ56X54.5	P2501197	08	SET SCREW	2	S435	M4X5	P9119420
03	REAR CASING	1	PPG	φ74X47	P2301038	04-2	BEARING	1	CERAMIC	φ11X31	P2461481	07	SCREEN/GROSS RECESS HEAD w/ L.P.W.(φ8Xφ4.3X10.8)	4	SUS304	M4X15	A9111026
02-1	FRONT THRUST PAD	1	RULON	φ10Xφ3X5	P2221021	04-1	INNER MAGNET	1	FERRITE	φ31X25	P2441485	06	O. RING	1	FKM	φ62.5Xφ2	563
02	FRONT CASING	1	PPG	φ74X46	P2211037	04	IMPELLER VANE	1	PPG	φ44.5X44	P2401198	05-2	OUTER MAGNET	1	FERRITE	φ52Xφ40X25	P2521486
01	MOTOR		BRUSH LESS , 17W , DC12V , DC24V			03-2	SPINDLE	1	CERAMIC	φ6X35	P2331479	05-1	MAGNET HOUSING	1	ADC-12	φ56Xφ54.5	P2511002

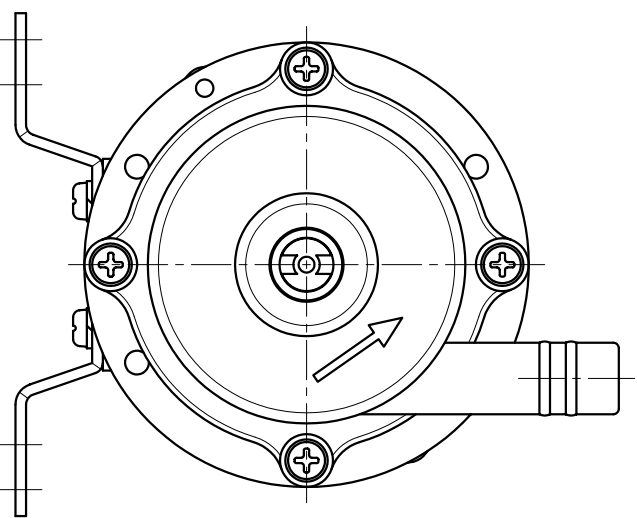
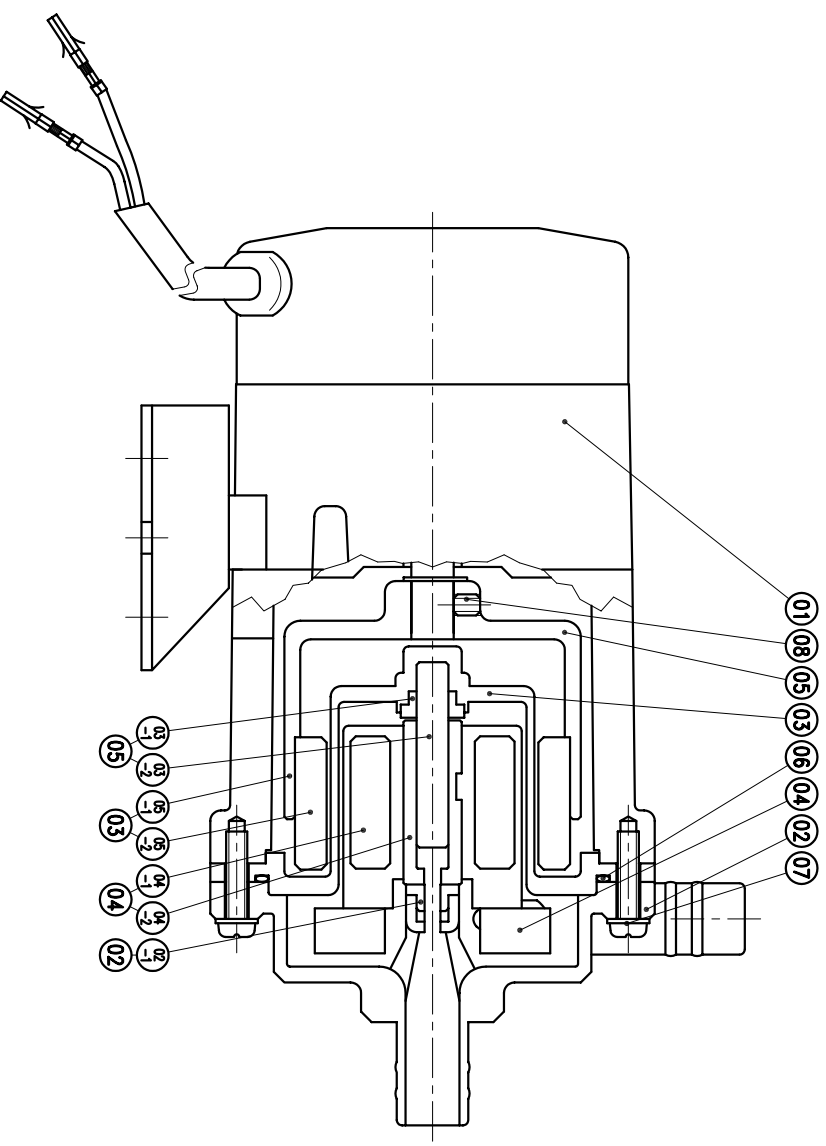

G : 3/4"X 3/4"
NPT : 3/4"X 3/4"

APPROVED	MDL NAME	NH-30PX-D
CHECK	DWG. NAME	CONSTRUCTION DRAWING
DESIGN	DWG. NO.	B2031539
DR.BY		A3
EDITION		

TPW
HONG YUAN



PAN WORLD CO., LTD.
パンワールド株式会社